

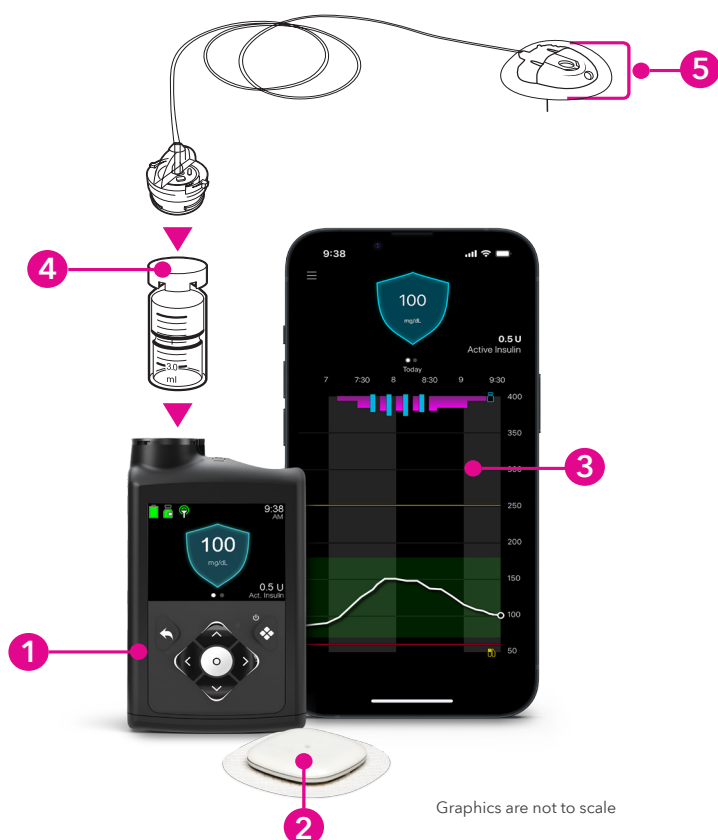

Understanding your MiniMed™ 780G system

MiniMed™ 780G system components



- 1 MiniMed™ 780G insulin pump**
The pump delivers insulin into your body through the infusion set.
- 2 Compatible MiniMed™ sensor**
Measures glucose in the fluid under your skin and sends sensor glucose values to the pump.
- 3 MiniMed™ Mobile app**
Get notified of highs and lows with the MiniMed™ Mobile app. Care partners can download the CareLink™ Connect app to stay in the know.
- 4 Reservoir**
Filled with insulin and placed in the pump. Connects to the tubing of the infusion set so that insulin can be delivered to your body.
- 5 Infusion set**
Connects to both the pump and your body. It carries the insulin as it is pushed out of the pump and is delivered in your body via the cannula.

How an insulin pump works

An insulin pump delivers continuous and customized doses of rapid-acting insulin 24 hours a day to match your needs. The pump delivers this insulin in two ways: basal and bolus.

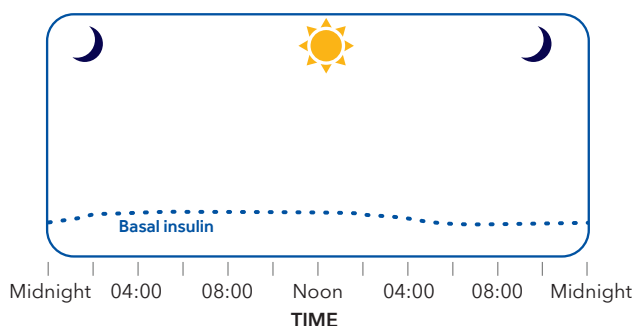

Basal insulin is the “background” insulin your pump delivers 24 hours a day to help keep your glucose levels in range between meals and while you sleep.

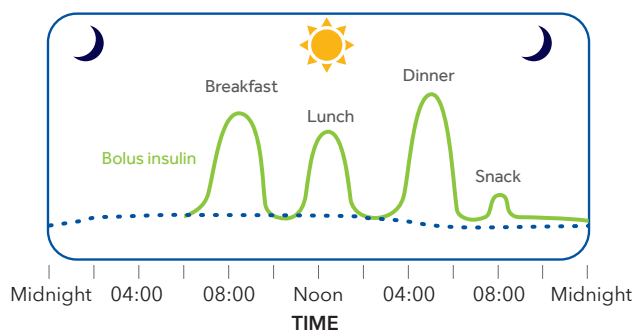

A **bolus** is a larger amount of insulin delivered when you eat or to correct a high glucose value



You will know you are in the SmartGuard™ feature by the blue shield on your home screen.



Understanding modes of delivery

Your pump has two modes: Manual Mode and SmartGuard™ technology

In **Manual Mode**, your pump works like a traditional pump. This means it uses the basal and bolus settings prescribed and programmed by your healthcare provider to deliver insulin. Your pump will be in Manual Mode (with or without a sensor) when you first start. During this time, you will use the Preset Bolus, Manual Bolus, or Bolus Wizard™ feature to deliver bolus insulin.

In **SmartGuard™ technology**, the pump automatically adjusts basal insulin delivery every 5 minutes based on your sensor glucose (SG) values. It can also automatically deliver a correction bolus to help correct SG values over 120 mg/dL. For this to work, you must wear a compatible MiniMed™ continuous glucose monitor (CGM).

Reminder: When in SmartGuard™ technology you will use the SmartGuard™ Bolus feature to deliver bolus insulin before meals.

Important safety information: MiniMed™ 780G system with SmartGuard™ technology with Guardian™ 4 sensor

The MiniMed™ 780G system is intended for continuous delivery of basal insulin at selectable rates, and the administration of insulin boluses at selectable amounts for the management of type 1 diabetes mellitus in persons seven years of age and older requiring insulin as well as for the continuous monitoring and trending of glucose levels in the fluid under the skin. The MiniMed™ 780G System includes SmartGuard™ technology, which can be programmed to automatically adjust insulin delivery based on the continuous glucose monitoring (CGM) sensor glucose values and can suspend delivery of insulin when the SG value falls below or is predicted to fall below predefined threshold values.

The Medtronic MiniMed™ 780G System consists of the following devices: MiniMed™ 780G Insulin Pump, the Guardian™ 4 Transmitter, the Guardian™ 4 Sensor, OnePress serter, the Accu-Chek™ Guide Link blood glucose meter, and the Accu-Chek™ Guide Test Strips. The system requires a prescription from a healthcare professional.

The Guardian™ 4 Sensor is intended for use with the MiniMed™ 780G system and the Guardian 4 transmitter to monitor glucose levels for the management of diabetes. The sensor is intended for single use and requires a prescription. The Guardian™ (4) sensor is indicated for **up to** seven days of continuous use.

The Guardian™ 4 sensor is not intended to be used directly to make therapy adjustments while the MiniMed™ 780G is operating in manual mode. All therapy adjustments in manual mode should be based on measurements obtained using a blood glucose meter and not on values provided by the Guardian™ 4 sensor. The Guardian™ 4 sensor has been studied and is approved for use in patients ages 7 years and older and in the arm insertion site only. Do not use the Guardian™ 4 sensor in the abdomen or other body sites including the buttocks, due to unknown or different performance that could result in hypoglycemia or hyperglycemia.

WARNING: Do not use the SmartGuard™ feature for people who require less than 8 units or more than 250 units of total daily insulin per day. A total daily dose of at least 8 units, but no more than 250 units, is required to operate in the SmartGuard™ feature.

WARNING: Do not use the MiniMed™ 780G system until appropriate training has been received from a healthcare professional. Training is essential to ensure the safe use of the MiniMed™ 780G system.

WARNING: Do not use SG values to make treatment decisions, including delivering a bolus, while the pump is in Manual Mode. When the SmartGuard™ feature is active and you are no longer in Manual Mode, the pump uses an SG value, when available, to calculate a bolus amount. However, if your symptoms do not match the SG value, use a BG meter to confirm the SG value. Failure to confirm glucose levels when your symptoms do not match the SG value can result in the infusion of too much or too little insulin, which may cause hypoglycemia or hyperglycemia.

Pump therapy is not recommended for people whose vision or hearing does not allow for the recognition of pump signals, alerts, or alarms. The safety of the MiniMed™ 780G system has not been studied in pregnant women, persons with type 2 diabetes, or in persons using other anti-hyperglycemic therapies that do not include insulin. For complete details of the system, including product and important safety information such as indications, contraindications, warnings and precautions associated with system and its components, please consult

<https://www.medtronicdiabetes.com/important-safety-information#minimed-780g> and the appropriate user guide at <https://www.medtronicdiabetes.com/download-library>.

US-DBA-2500283 © 2025 Medtronic. MiniMed and MiniMed logo are the trademarks of Medtronic MiniMed, Inc.™ Third-party brands are trademarks of their respective owners.

All other brands are trademarks of a Medtronic company. ACCU-CHEK, ACCU-CHEK GUIDE, ACCU-CHEK FASTCLIX, and ACCU-CHEK SOFTCLIX are trademarks of Roche Diabetes Care.

Medtronic